

SchoolLockers.com

1-800-952-0151

Cell Phone Lockers

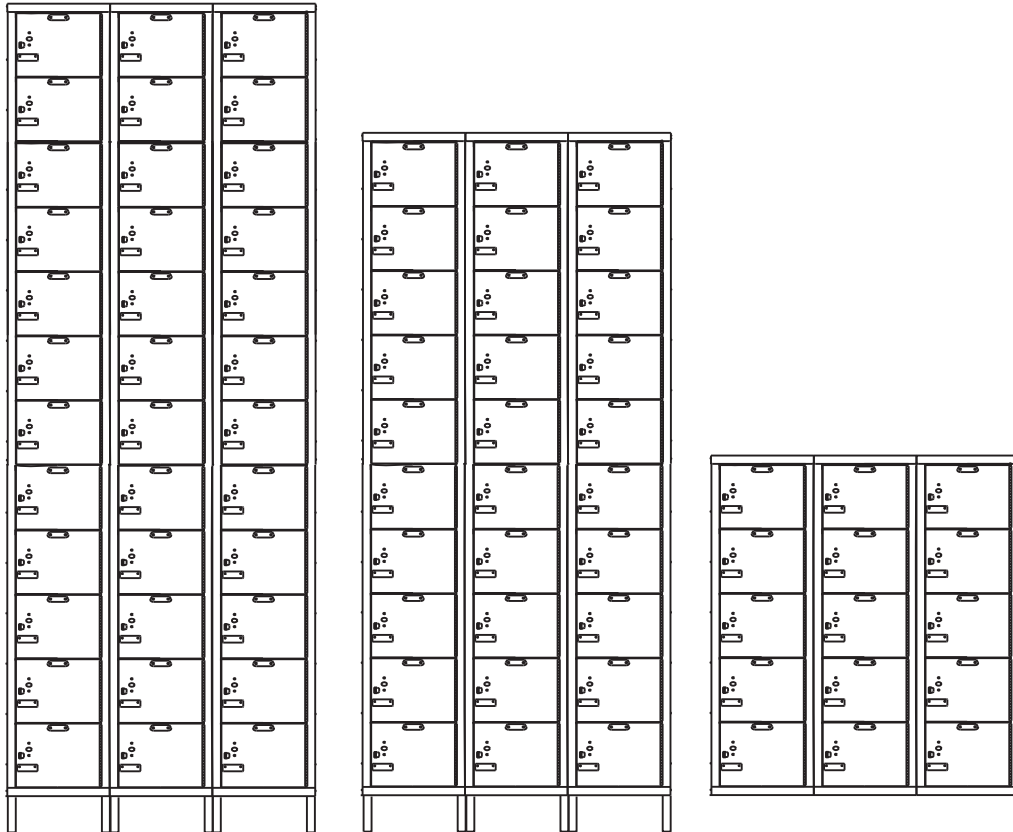

General Instructions

1. Check material received against the packing list. First check the number of packages received and then check the contents of each package.
2. Check material received for damage. If damage has occurred, secure a "damage notation" from the carrier.
3. Identify each part as it is unpacked and put like parts together as close as possible to the working area in which they are to be assembled.
4. Be careful to use the correct hardware as specified in the assembly instructions.

CAUTION

IN THE INTEREST OF SAFETY, ALL LOCKERS MUST BE SECURELY ANCHORED TO THE FLOOR AND/OR WALL.
FOR SAFETY, HANDLE ALL COMPONENTS CAREFULLY AND WEAR WORK-GLOVES WHEN ASSEMBLING LOCKERS.
INSTALL ALL UNITS PLUMB AND TIGHTEN ALL HARDWARE SECURELY.
RETAIN INSTRUCTIONS FOR FUTURE REFERENCE.

PACKAGE CONTENTS

REF. NO.	DESCRIPTION	1-WIDE QTY	3-WIDE QTY
①	REAR PANEL	1	3
②	RIGHT/LEFT SIDE PANEL	2	4
③	TOP/BOTTOM SHELF	2	6
④	INTERMEDIATE SHELF	5	15
⑤	DOOR FRAME ASSEMBLY	1	3
x ⑥	DOOR	6	18
⑦	BOX DOOR LATCH PULL	6	18
⑧	NUMBER PLATE	6	18
⑨	NUMBER PLATE RIVET	12	36
xx ⑩	STRIKE PLATE	xx6	xx18
⑪	REAR LEG	2	2
⑫	3/8" SLOTLESS BOLT	94	282
⑬	HEX NUT	82	246
⑭	HI-DOME CAP NUT	12	36
x ⑮	PIANO HINGE	6	12
x ⑯	RIVET (HINGE)	12	36

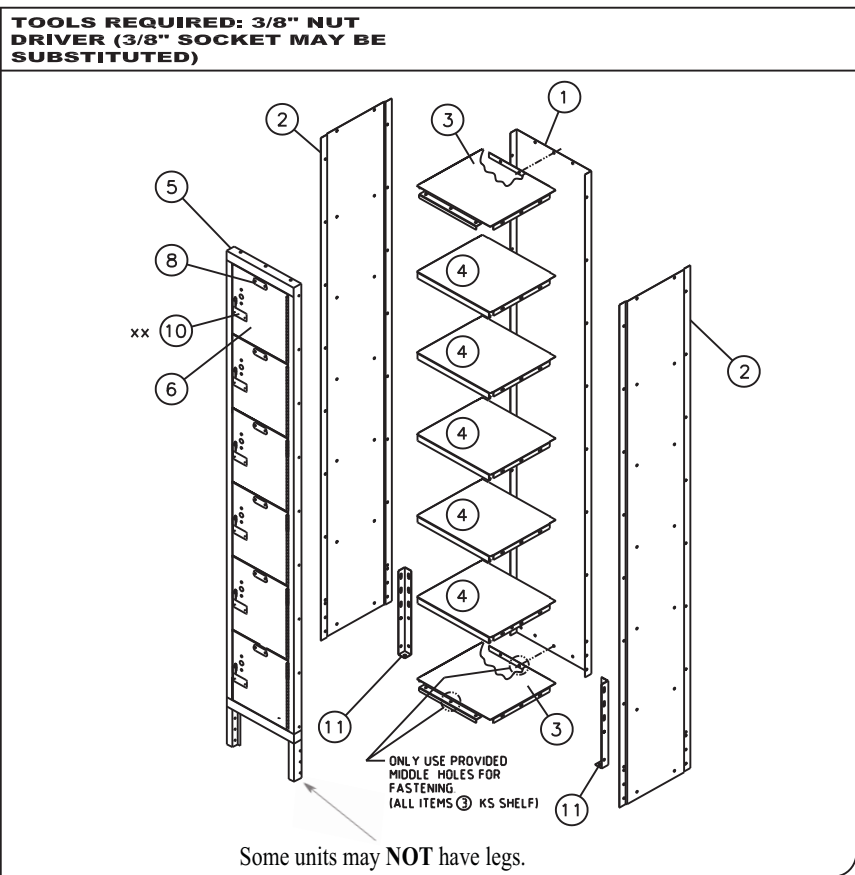

NOTE:

- x SHIPS PRE-HUNG IN DOOR FRAME ASSEMBLY.
- xx STRIKE PLATES ARE OPTIONAL - INCLUDES TWO RIVETS ⑨.

ASSEMBLY OF SINGLE ROW LOCKERS NEVER PUT SIDE PANELS BETWEEN FRAMES.

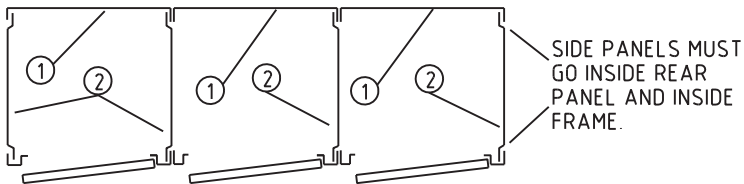

3-WIDE UNIT PLAN VIEW

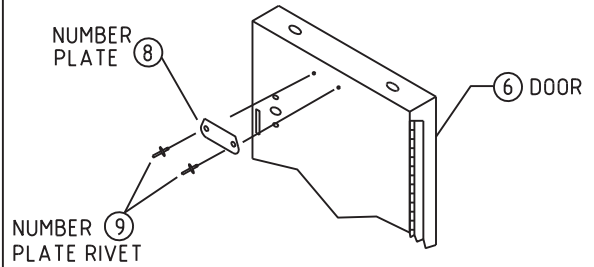

ASSEMBLY OF NUMBER PLATE

HARDWARE USED FOR MAIN LOCKER ASSEMBLY

⑫ SLOTLESS BOLT



10 - 24 x 3/8"

⑬ HEX NUT



TIGHTEN NUT WITH A NUT DRIVER OR WRENCH

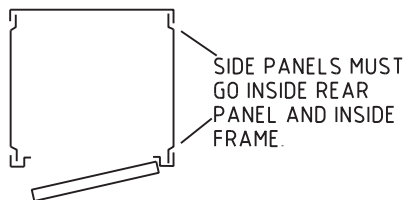

TOP VIEW OF 1-WIDE
FOLLOW BASIC INSTRUCTIONS
FROM 3-WIDE ASSEMBLY

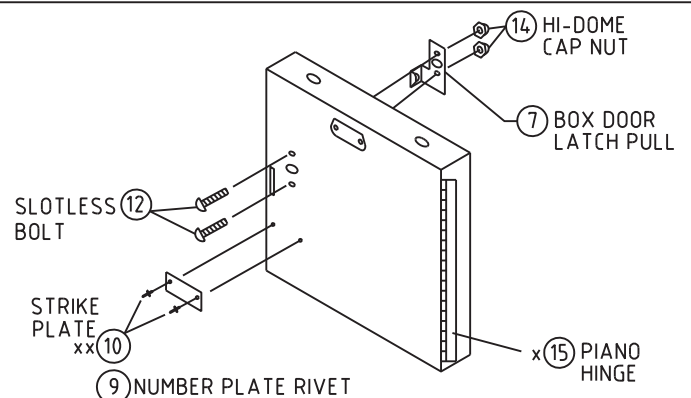

ASSEMBLY OF STRIKE PLATE & LATCH PULL

SchoolLockers.com

1-800-952-0151

3 WIDE UNIT

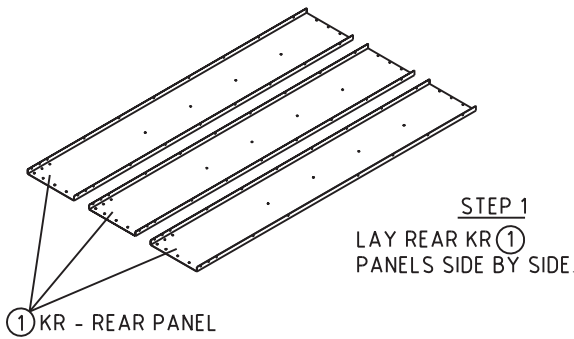

STEP 1
LAY REAR KR ①
PANELS SIDE BY SIDE.

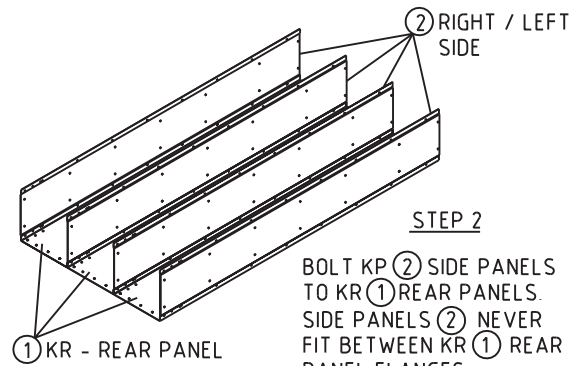

STEP 2
BOLT KP ② SIDE PANELS
TO KR ① REAR PANELS.
SIDE PANELS ② NEVER
FIT BETWEEN KR ① REAR
PANEL FLANGES.

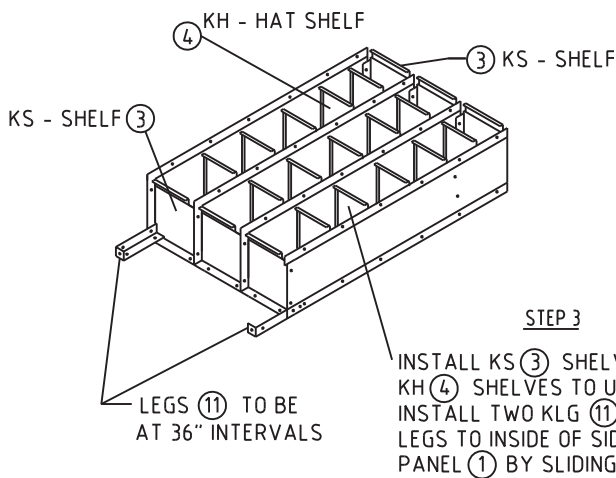

STEP 3
INSTALL KS ③ SHELVES AND
KH ④ SHELVES TO UNIT.
INSTALL TWO KLG ⑪ REAR
LEGS TO INSIDE OF SIDE ② AND REAR
PANEL ① BY SLIDING INTO PLACE FROM BOTTOM.

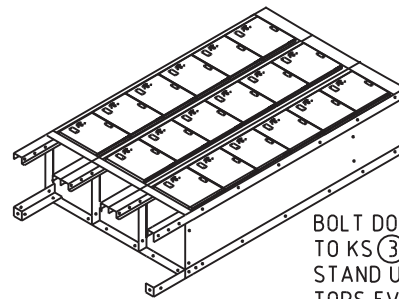

STEP 4
BOLT DOOR AND FRAME ⑤ ASSEMBLIES
TO KS ③ SHELVES AND KP ② SIDE PANELS.
STAND UNIT UP AND ALIGN LOCKER
TOPS EVENLY. TIGHTEN ALL BOLTS
AND NUTS.
NOTE: WHEN BOLTING ONE UNIT TO
ANOTHER, OMIT ONE SET OF BOLTS
IN END FRAME AND SIDE TO MINIMIZE
GROWTH FROM BOLT HEADS.

1 WIDE UNIT

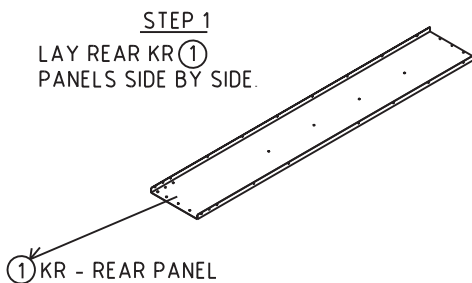

STEP 1
LAY REAR KR ①
PANELS SIDE BY SIDE.

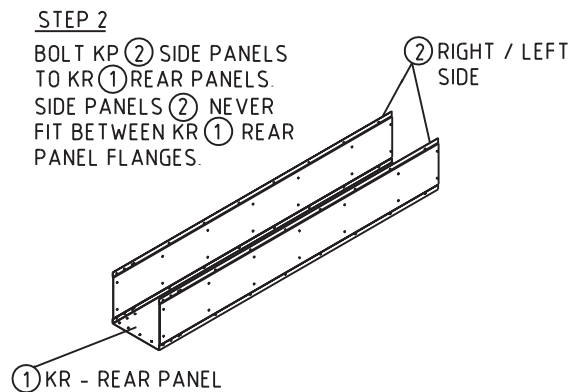

STEP 2
BOLT KP ② SIDE PANELS
TO KR ① REAR PANELS.
SIDE PANELS ② NEVER
FIT BETWEEN KR ① REAR
PANEL FLANGES.

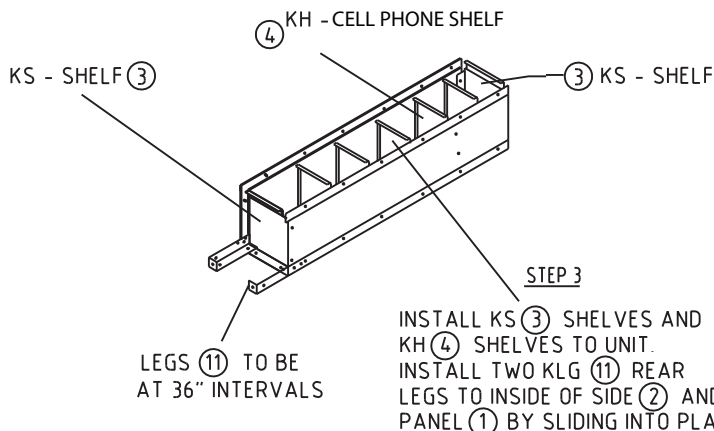

STEP 3
INSTALL KS ③ SHELVES AND
KH ④ SHELVES TO UNIT.
INSTALL TWO KLG ⑪ REAR
LEGS TO INSIDE OF SIDE ② AND REAR
PANEL ① BY SLIDING INTO PLACE FROM BOTTOM.

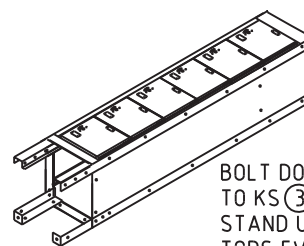

STEP 4
BOLT DOOR AND FRAME ⑤ ASSEMBLIES
TO KS ③ SHELVES AND KP ② SIDE PANELS.
STAND UNIT UP AND ALIGN LOCKER
TOPS EVENLY. TIGHTEN ALL BOLTS
AND NUTS.
NOTE: WHEN BOLTING ONE UNIT TO
ANOTHER, OMIT ONE SET OF BOLTS
IN END FRAME AND SIDE TO MINIMIZE
GROWTH FROM BOLT HEADS.