

LOCKER SHELF™

The Ultimate in Locker Shelving

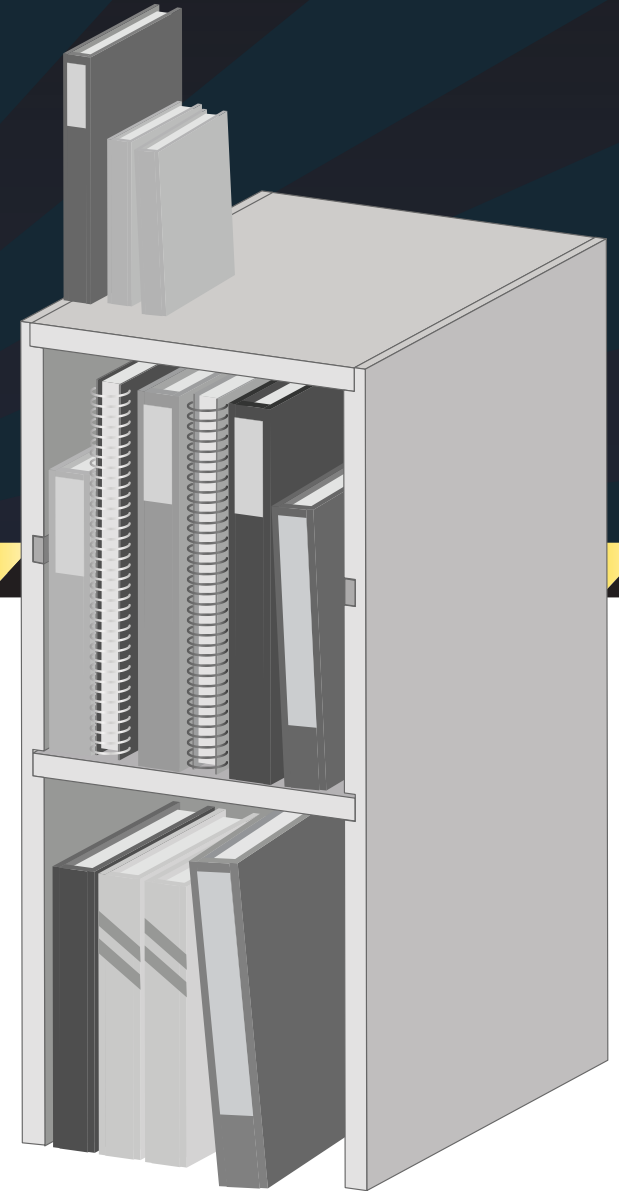

DOUBLE LOCKER SHELF

Designed to Fit • Built to Last

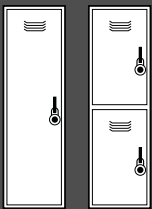

FITS SINGLE-TIER
AND DOUBLE-TIER
LOCKERS

COMES IN THREE SIZES

9
inch

12
inch

15
inch

SchoolLockers.com





THE STORY

Tom Moritz, designer of the LockerShelf™ concept, frustrated by the lack of available solutions developed the LockerShelf™ for his own children.

“Once my son entered middle school he immediately realized that keeping all his books, notebooks and folders (not to mention his backpack, lunch and jacket) crammed into his locker in one pile was not going to work for him—he wanted...needed shelves. We searched the internet and found a few options, but it was obvious that most of them would not perform well or stand up to the rigors of daily use. Many of the shelves either did not fit his locker or were poorly designed. Some of the adjustable shelves were not only difficult to assemble in the locker but were compromised in terms of strength and durability. So we had no choice but to build our own.”

WHY A LOCKER SHELF?

Our children have lots of stuff these days, and lockers, being long and narrow compartments with virtually no shelving, makes it difficult for them to stay organized. The average child will probably access his/her locker over 8000 times during his/her school experience so why not give them the tools to stay organized—especially something as simple as locker shelves!

LockerShelf™ was created for exactly this purpose: to provide a locker shelf solution that will help children get organized and make the most of their academic experience.

WHAT IS A LOCKERSHELF?

A **LockerShelf™** is a double shelf system designed to fit lockers like “built in” shelving.

Manufactured out of high-strength hollow-core PVC, the **LockerShelf™** has a patented design that provides a rigid, durable, light-weight and cost-effective solution. By utilizing the external frame of the locker for the strength all the weight is transferred vertically through the **LockerShelf™** yielding a strong and solid fit. Even better, the innovative design makes installation a snap: just four simple steps make it so easy even a grown-up can do it! Once installed the **LockerShelf™** provides three levels of storage (the locker floor plus two shelves) and is ready for whatever load a kid can throw at it. The rugged design also allows us to warranty each **LockerShelf™** for one full year (please see warranty statement).

Better Yet: They are delivered in a handy box with a handle that makes carrying them to school a breeze.

WILL THEY FIT?

Of course! They are “designed to fit.” A little known fact is that the vast majority of school lockers come in three standard sizes; 9”, 12” and 15” (with 12” being the most common). This fact allows **LockerShelf™** to build shelving to precisely match these dimensions—you just need to determine what size locker you have and presto!! A perfect fit every time. See the installation page to quickly determine your locker size!

LockerShelf™ is also designed to fit either single-tier (i.e one tall locker) or double-tier (2 vertical lockers) provided the width of the locker is either 9”, 12” or 15.”

Most Asked
Question!

ARE THEY ADJUSTABLE?

The **LockerShelf™** can be installed in a number of different configurations to meet each individual student's organizational needs.

Second Most Asked Question!

As shown below there are 5 different configurations of the **LockerShelf™**. The single shelf configuration might be more desirable for the double-tier lockers whereas the double shelf configurations are ideal for single-tier or taller lockers. Any configuration of the shelves fit in both the single or double-tier lockers. It is strictly a matter of personal preference. Our favorite configuration is the conventional set-up with two large compartments.

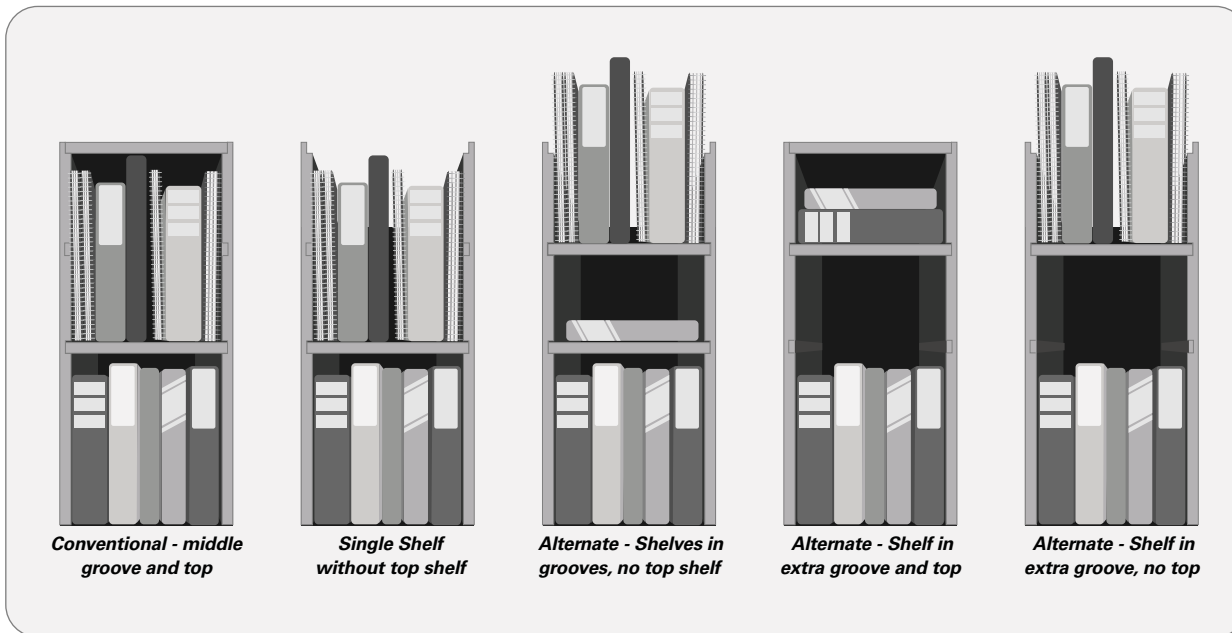

Locker shelves should be a necessary part of school equipment. They foster great organization skills, help kids keep all the important school items in order, and make the most out of locker space...

Even though there are many good reasons to buy locker shelves there is one solution that really works... Buy a **LockerShelf™** today!



HOW MUCH DO THEY COST?

The 9" and 12" models are available for \$19.99. The 15" model is \$20.99. A small investment for years of use!

WHERE CAN I BUY A LOCKERSHELF™?

You can order your LockerShelf™ online. Our web address is <http://www.lockershelfco.com>

ONE YEAR WARRANTY

When used in locker in accordance to installation instruction. Customer responsible for shipping and handling. See website for more details.



Shelf assembly fits snugly against side of locker so papers, pens and pencils can't fall through the cracks.

A second groove provides added flexibility and adjustability.

Sized to handle extra large folders, binders and books.

Precision-cut groove that makes shelves easy to install as well as providing strength and stability.

Constructed of 70% recycled hollow-core PVC that yields incredible strength (>150lbs) and durability with minimal weight.

INTERCHANGEABLE SHELVES

If the locker size changes as the student moves from middle school to high school new shelves can be ordered without replacing the whole assembly.

ANATOMY OF A LOCKERSHELF™

STANDARD INSTALLATION

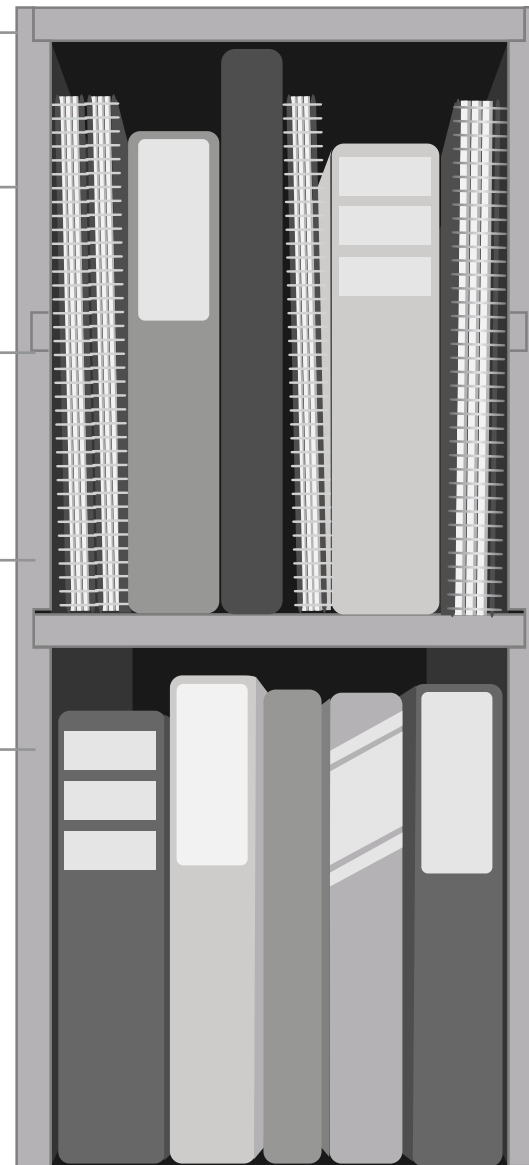

INSTALLS QUICKLY AND EASILY

STANDARD INSTALLATION

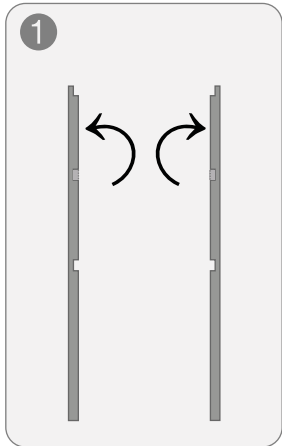

1 Insert the two side panels into the locker with the grooves on each panel facing inward and the notched ends up.

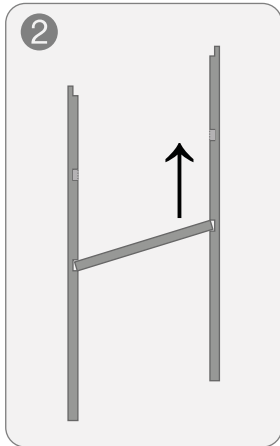

2 Slide one panel up the side wall and insert the bottom shelf into the grooves in the side panels.

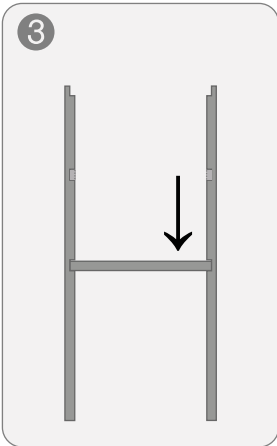

3 Slide the side panel down, locking the shelf into place.

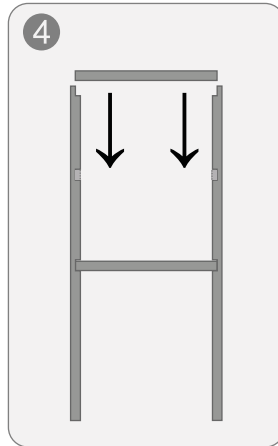

4 Position topshelf on top of side panels and align components as necessary.

ALTERNATE INSTALLATION

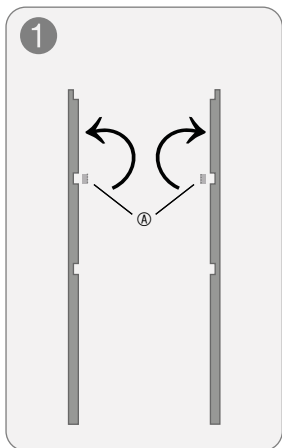

Ⓐ Remove the caps from the middle grooves and insert the two side panels into the locker with the grooves on each panel facing inward and the notched ends up.

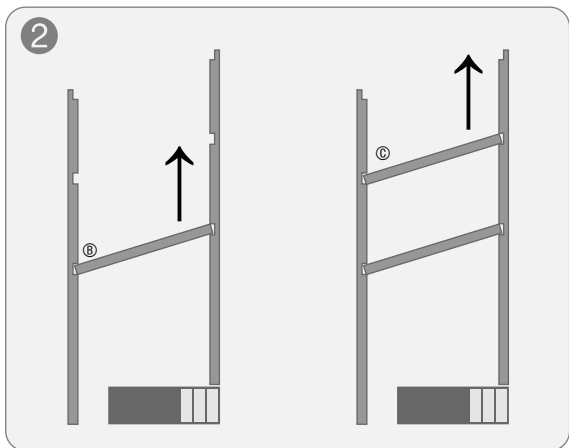

2 Slide one panel up the side wall. You may want to place a book under the shelf to make it easier to insert the two shelves into the grooves in the side panels. Insert shelf Ⓒ into the two lowest grooves and shelf Ⓓ into the middle grooves.

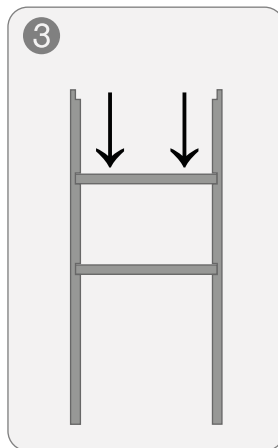

3 Remove the book and slide the side panel down, locking the shelf Ⓓ in place.



DOUBLE LOCKER SHELF Installation Instructions

HOW TO MEASURE

Since lockers come in standard incremental sizes (9,12 and 15") it is easy to determine the locker width using only a standard piece of 8.5" x 11" paper.

Here's how... Place the paper in the locker short side first and if the inside width of the locker is only slightly larger, then your locker is a 9"; if it is much wider then turn the paper so the longer side fits inside width of the locker. If the inside of the locker is only slightly wider then it is a 12" and if it is a lot wider then it is a 15"

Of course you can always use a tape measure!



877.952.0151