

72" HIGH DOUBLE TIER ALL-WELDED DEFIANT II LOCKER

TYPICAL FOR 12" & 15" WIDE
TYPICAL FOR 12", 15", 18" & 21" DEEP

ALUMINUM NUMBER PLATE
(FIELD INSTALL)

ONE DOUBLE PRONG CEILING
HOOK & TWO SINGLE PRONG
WALL HOOKS EACH OPENING

LOCK HOLE COVER PLATE

STAINLESS STEEL DEFIANT
HANDLE W/ PADLOCK HASP

16GA. FRAME ASSEMBLY &
14GA. DIAMOND PERF. DOOR W/
REINFORCMENT PAN

18GA. SOLID BACK

CONTINUOUS HINGE

Sold By

SchoolLockers.com

877.952.0151

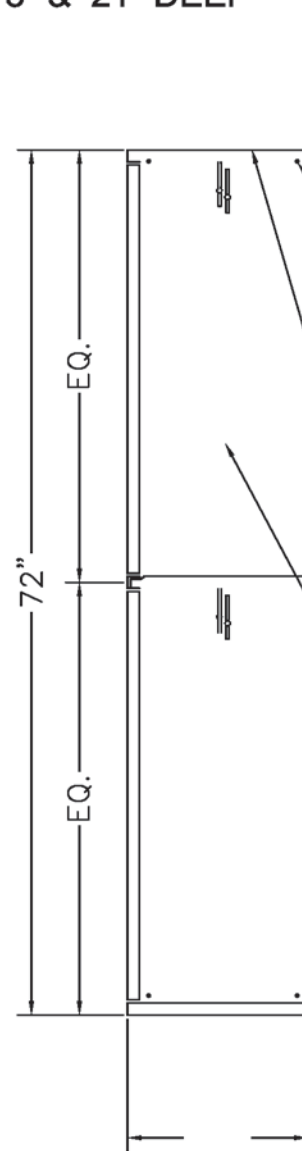
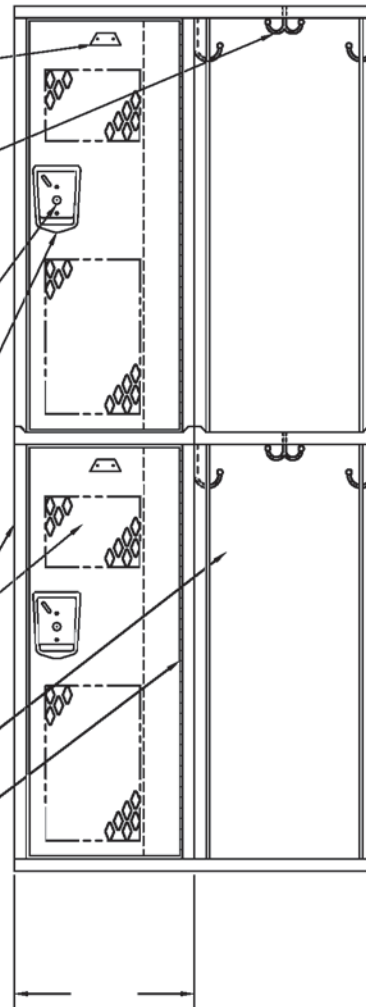

BOLT WELDED LOCKER UNITS
TOGETHER @ 4 PLACES TYP.

ANCHOR LOCKERS TIGHT
TO WALL @ 36" O.C.
(ANCHORS BY OTHERS)

16GA. TOP, BOTTOM &
SHELF/TIER HEAD

16GA. DIAMOND PERF. DIVISION
SOLID @ ROW ENDS

ALLOW 1/16" CREEPAGE PER FRAME

72" HIGH DOUBLE TIER ALL-WELDED DEFIANT II LOCKER

TYPICAL FOR 18" WIDE
TYPICAL FOR 15", 18", 21" & 24" DEEP

ALUMINUM NUMBER PLATE
(FIELD INSTALL)

ONE DOUBLE PRONG CEILING
HOOK & FOUR SINGLE PRONG
WALL HOOKS EACH OPENING

LOCK HOLE COVER PLATE

STAINLESS STEEL DEFIANT
HANDLE W/ PADLOCK HASP

16GA. FRAME ASSEMBLY &
14GA. DIAMOND PERF. DOOR W/
REINFORCMENT PAN

18GA. SOLID BACK

CONTINUOUS HINGE

BOLT WELDED LOCKER UNITS
TOGETHER @ 4 PLACES TYP.

ANCHOR LOCKERS TIGHT
TO WALL @ 36" O.C.
(ANCHORS BY OTHERS)

16GA. TOP, BOTTOM &
SHELF/TIER HEAD

16GA. DIAMOND PERF
DIVISION, SOLID @ ROW
END

Sold By
SchoolLockers.com
877.952.0151

ALLOW 1/16" CREEPAGE PER FRAME

99 BROWER AVE. P.O. BOX 378 OAKS, PA 19456-0378
TEL: (800) 562-1000, (610) 666-0500 FAX: (610) 666-7561

This drawing shows a standard Penco Product. Any Modification
to the product must be approved by Penco Engineering. 9/15/2006



72" HIGH DOUBLE TIER ALL-WELDED DEFIANT II LOCKER

TYPICAL FOR 24" WIDE
TYPICAL FOR 18", 21" & 24" DEEP

ALUMINUM NUMBER PLATE
(FIELD INSTALL)

ONE DOUBLE PRONG CEILING
HOOK & FOUR SINGLE PRONG
WALL HOOKS EACH OPENING

LOCK HOLE COVER PLATE

STAINLESS STEEL DEFIANT
HANDLE W/ PADLOCK HASP

16GA. FRAME ASSEMBLY &
14GA. DIAMOND PERF. DOOR W/
REINFORCMENT PAN

18GA. SOLID BACK

CONTINUOUS HINGE

BOLT WELDED LOCKER UNITS
TOGETHER @ 4 PLACES TYP.

ANCHOR LOCKERS TIGHT
TO WALL @ 36" O.C.
(ANCHORS BY OTHERS)

16GA. TOP, BOTTOM &
SHELF/TIER HEAD

16GA. DIAMOND PERF
DIVISION, SOLID @ ROW
END

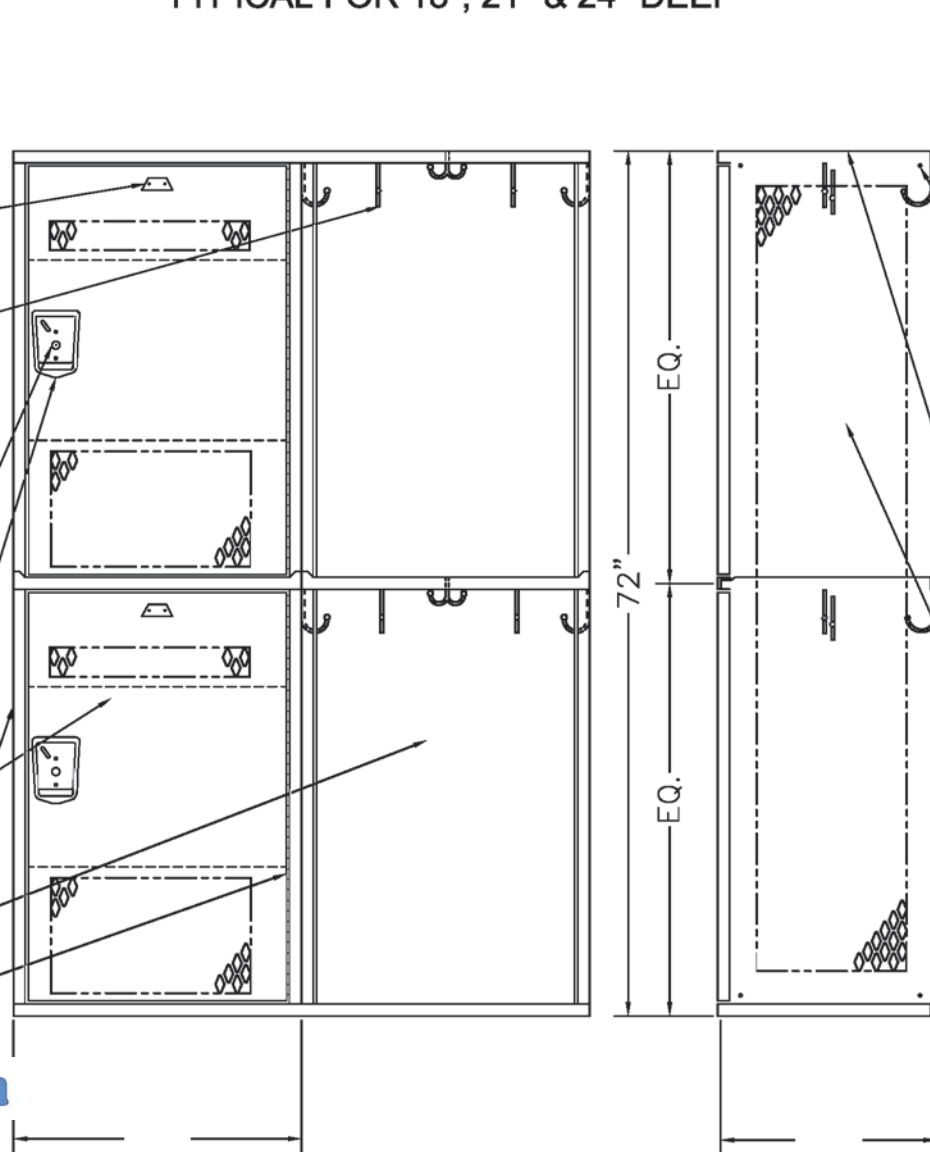

ALLOW 1/16" CREEPAGE PER FRAME

Sold By

SchoolLockers.com

877.952.0151

99 BROWER AVE. P.O. BOX 378 OAKS, PA 19456-0378
TEL: (800) 562-1000, (610) 666-0500 FAX: (610) 666-7561

This drawing shows a standard Penco Product. Any Modification
to the product must be approved by Penco Engineering. 9/15/2006

241872AWD2T.DWG



60" HIGH DOUBLE TIER ALL-WELDED DEFIANT II LOCKER

TYPICAL FOR 12" & 15" WIDE
TYPICAL FOR 12", 15", 18" & 21" DEEP

ALUMINUM NUMBER PLATE
(FIELD INSTALL)

ONE DOUBLE PRONG CEILING
HOOK & TWO SINGLE PRONG
WALL HOOKS EACH OPENING

LOCK HOLE COVER PLATE

STAINLESS STEEL DEFIANT
HANDLE W/ PADLOCK HASP

16GA. FRAME ASSEMBLY &
14GA. DIAMOND PERF. DOOR W/
REINFORCMENT PAN

18GA. SOLID BACK

CONTINUOUS HINGE

Sold By

SchoolLockers.com

877.952.0151

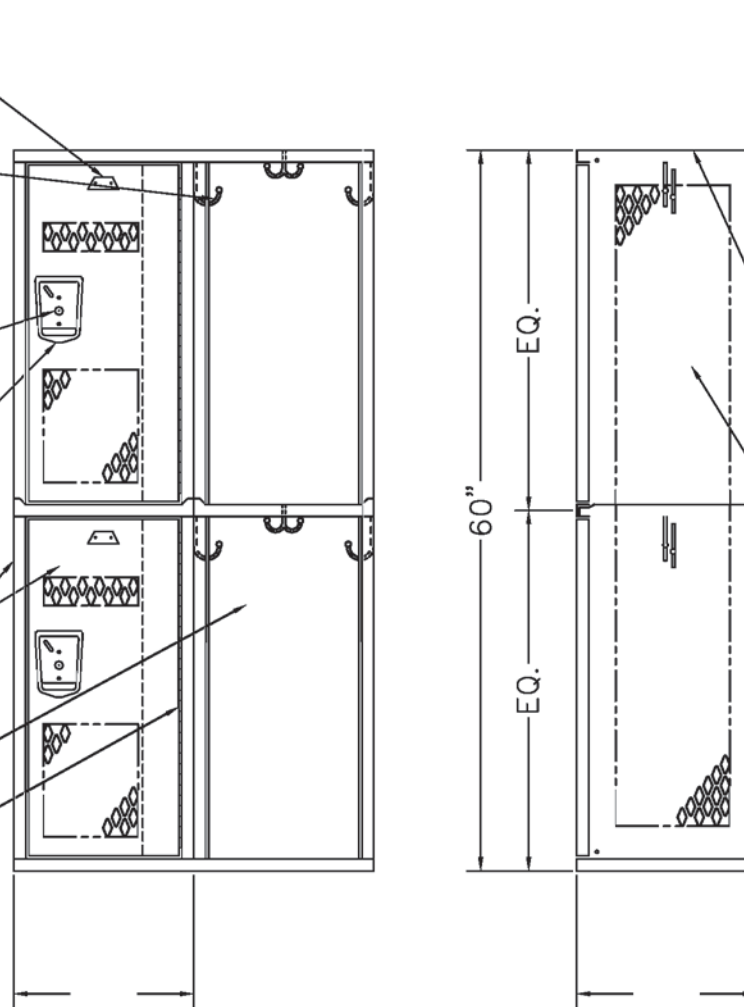

BOLT WELDED LOCKER UNITS
TOGETHER @ 4 PLACES TYP.

ANCHOR LOCKERS TIGHT
TO WALL @ 36" O.C.
(ANCHORS BY OTHERS)

16GA. TOP, BOTTOM &
SHELF/TIER HEAD

16GA. DIAMOND PERF. DIVISION
SOLID @ ROW ENDS

ALLOW 1/16" CREEPAGE PER FRAME

60" HIGH DOUBLE TIER ALL-WELDED DEFIANT II LOCKER

TYPICAL FOR 18" WIDE
TYPICAL FOR 15", 18", 21" & 24" DEEP

ALUMINUM NUMBER PLATE
(FIELD INSTALL)

ONE DOUBLE PRONG CEILING
HOOK & FOUR SINGLE PRONG
WALL HOOKS EACH OPENING

LOCK HOLE COVER PLATE

STAINLESS STEEL DEFIANT
HANDLE W/ PADLOCK HASP

16GA. FRAME ASSEMBLY &
14GA. DIAMOND PERF. DOOR W/
REINFORCMENT PAN

18GA. SOLID BACK

CONTINUOUS HINGE

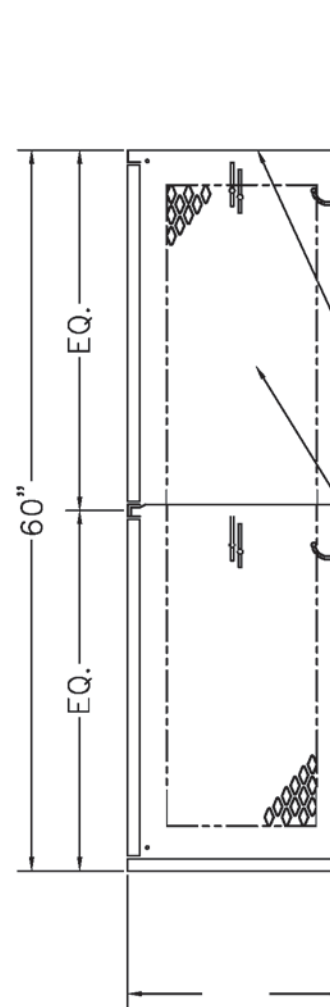
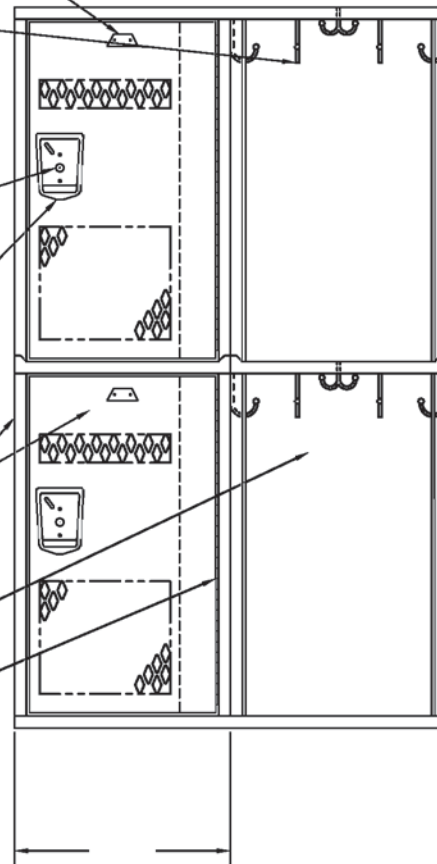

BOLT WELDED LOCKER UNITS
TOGETHER @ 4 PLACES TYP.

ANCHOR LOCKERS TIGHT
TO WALL @ 36" O.C.
(ANCHORS BY OTHERS)

16GA. TOP, BOTTOM &
SHELF/TIER HEAD

16GA. DIAMOND PERF
DIVISION, SOLID @ ROW
END

Sold By

SchoolLockers.com

877.952.0151

ALLOW 1/16" CREEPAGE PER FRAME

99 BROWER AVE. P.O. BOX 378 OAKS, PA 19456-0378
TEL: (800) 562-1000, (610) 666-0500 FAX: (610) 666-7561

This drawing shows a standard Penco Product. Any Modification
to the product must be approved by Penco Engineering. 9/15/2006

181860AWD2T.DWG



60" HIGH DOUBLE TIER ALL-WELDED DEFIANT II LOCKER

TYPICAL FOR 24" WIDE
TYPICAL FOR 18", 21" & 24" DEEP

ALUMINUM NUMBER PLATE
(FIELD INSTALL)

ONE DOUBLE PRONG CEILING
HOOK & FOUR SINGLE PRONG
WALL HOOKS EACH OPENING

LOCK HOLE COVER PLATE

STAINLESS STEEL DEFIANT
HANDLE W/ PADLOCK HASP

16GA. FRAME ASSEMBLY &
14GA. DIAMOND PERF. DOOR W/
REINFORCMENT PAN

18GA. SOLID BACK

CONTINUOUS HINGE

Sold By

SchoolLockers.com

877.952.0151

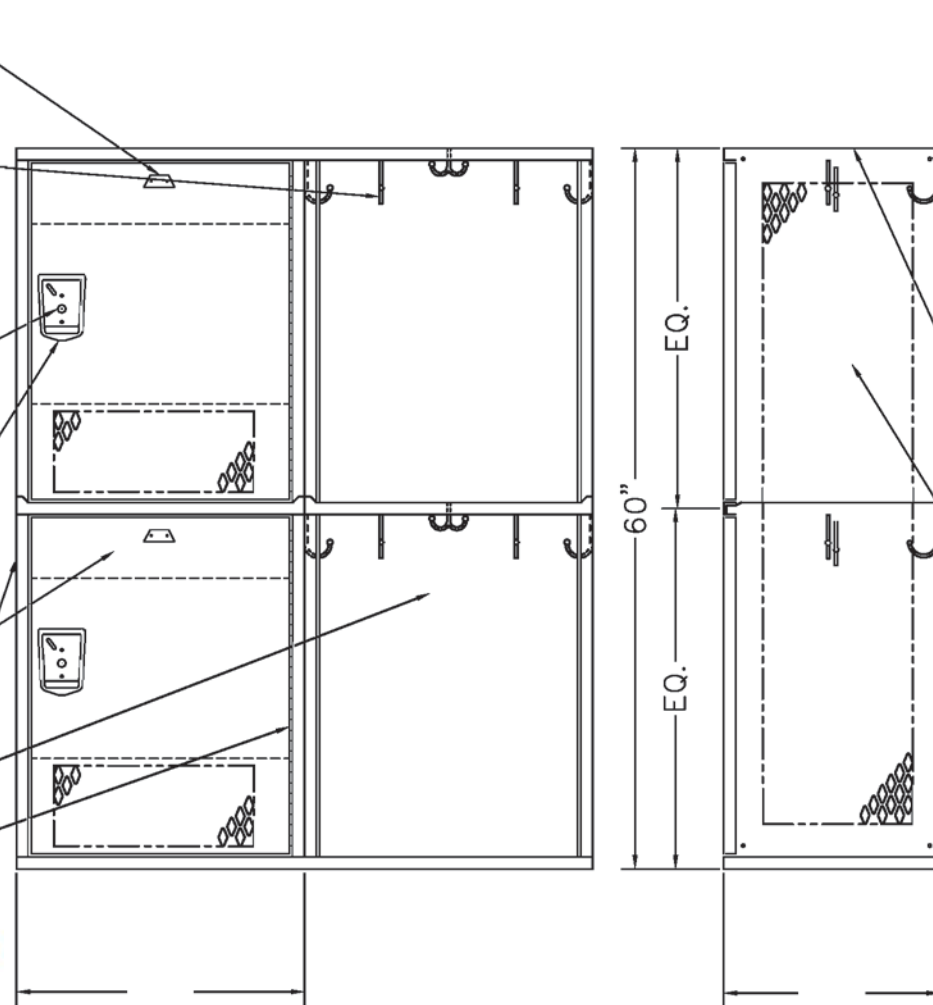

BOLT WELDED LOCKER UNITS
TOGETHER @ 4 PLACES TYP.

ANCHOR LOCKERS TIGHT
TO WALL @ 36" O.C.
(ANCHORS BY OTHERS)

16GA. TOP, BOTTOM &
SHELF/TIER HEAD

16GA. DIAMOND PERF
DIVISION, SOLID @ ROW
END

ALLOW 1/16" CREEPAGE PER FRAME