

# 72" HIGH DOUBLE TIER INVINCIBLE II DEFIANT II LOCKER

TYPICAL FOR 12" WIDE  
TYPICAL FOR 12", 15" & 18" DEEP

ALUMINUM NUMBER PLATE  
(FIELD INSTALL)

ONE DOUBLE PRONG CEILING  
HOOK & THREE SINGLE PRONG  
WALL HOOKS EACH OPENING  
(FIELD INSTALL)

LOCK HOLE COVER PLATE

STAINLESS STEEL DEFIANT  
HANDLE W/ PADLOCK HASP

16GA. FRAME ASSEMBLY &  
14GA. DIAMOND PERF. DOOR W/  
REINFORCMENT PAN

18GA. SOLID BACK

CONTINUOUS HINGE

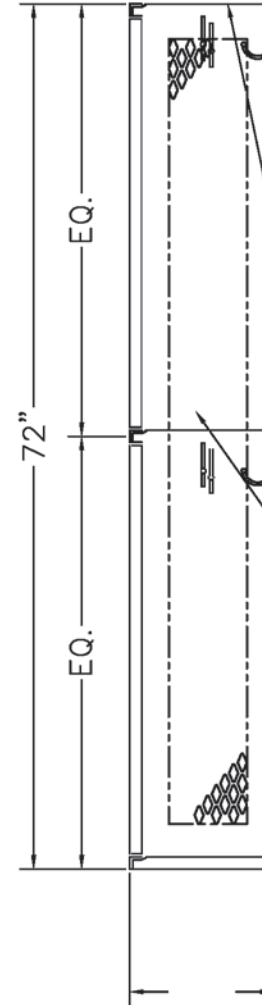
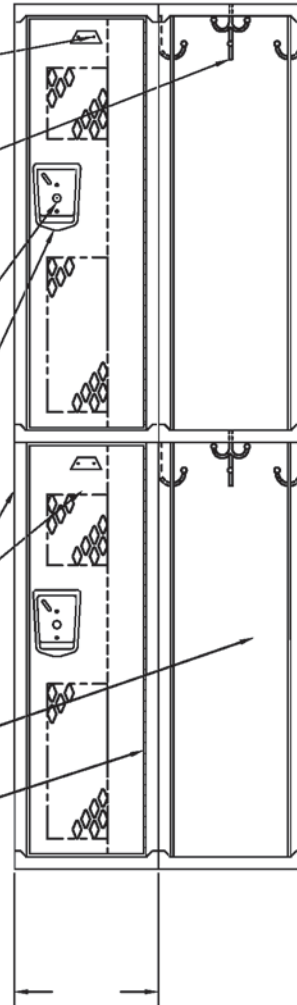

ANCHOR LOCKERS TIGHT  
TO WALL @ 36" O.C.  
(ANCHORS BY OTHERS)

16GA. TOP, BOTTOM &  
SHELF/TIER HEAD

16GA. DIAMOND PERF. DIVISION  
SOLID @ ROW ENDS

Sold By

**SchoolLockers.com**

877.952.0151

ALLOW 1/16" CREEPAGE PER FRAME

# 60" HIGH DOUBLE TIER INVINCIBLE II DEFIANT II LOCKER

TYPICAL FOR 12" WIDE  
TYPICAL FOR 12", 15" & 18" DEEP

ALUMINUM NUMBER PLATE  
(FIELD INSTALL)

ONE DOUBLE PRONG CEILING  
HOOK & THREE SINGLE PRONG  
WALL HOOKS EACH OPENING  
(FIELD INSTALL)

LOCK HOLE COVER PLATE

STAINLESS STEEL DEFIANT  
HANDLE W/ PADLOCK HASP

16GA. FRAME ASSEMBLY &  
14GA. DIAMOND PERF. DOOR W/  
REINFORCMENT PAN

18GA. SOLID BACK

CONTINUOUS HINGE

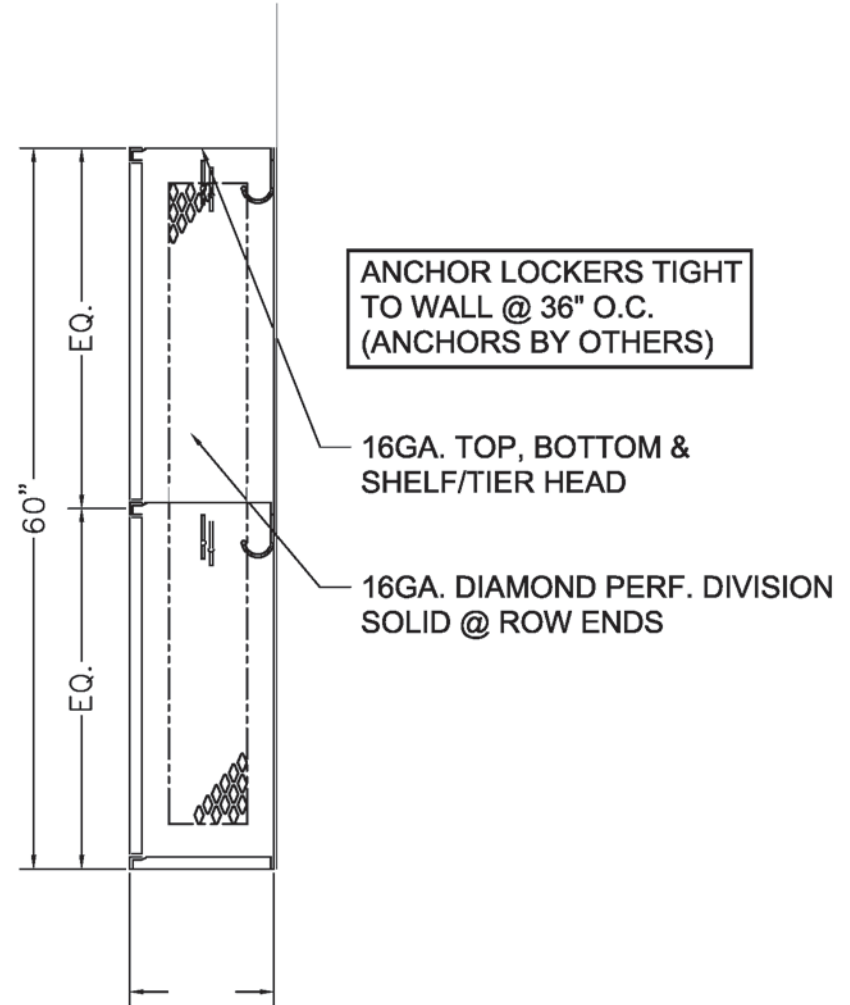

Sold By

**SchoolLockers.com**

877.952.0151

ALLOW 1/16" CREEPAGE PER FRAME

99 BROWER AVE. P.O. BOX 378 OAKS, PA 19456-0378  
TEL: (800) 562-1000, (610) 666-0500 FAX: (610) 666-7561

This drawing shows a standard Penco Product. Any Modification  
to the product must be approved by Penco Engineering. 9/15/2006

121260INVD2T.DWG



# 60" HIGH DOUBLE TIER INVINCIBLE II DEFIANT II LOCKER

TYPICAL FOR 15" & 18" WIDE  
TYPICAL FOR 15" , 18" , 21" & 24" DEEP

ALUMINUM NUMBER PLATE  
(FIELD INSTALL)

ONE DOUBLE PRONG CEILING  
HOOK & FOUR SINGLE PRONG  
WALL HOOKS EACH OPENING  
(FIELD INSTALL)

LOCK HOLE COVER PLATE

STAINLESS STEEL DEFIANT  
HANDLE W/ PADLOCK HASP

16GA. FRAME ASSEMBLY &  
14GA. DIAMOND PERF. DOOR W/  
REINFORCMENT PAN

18GA. SOLID BACK

CONTINUOUS HINGE

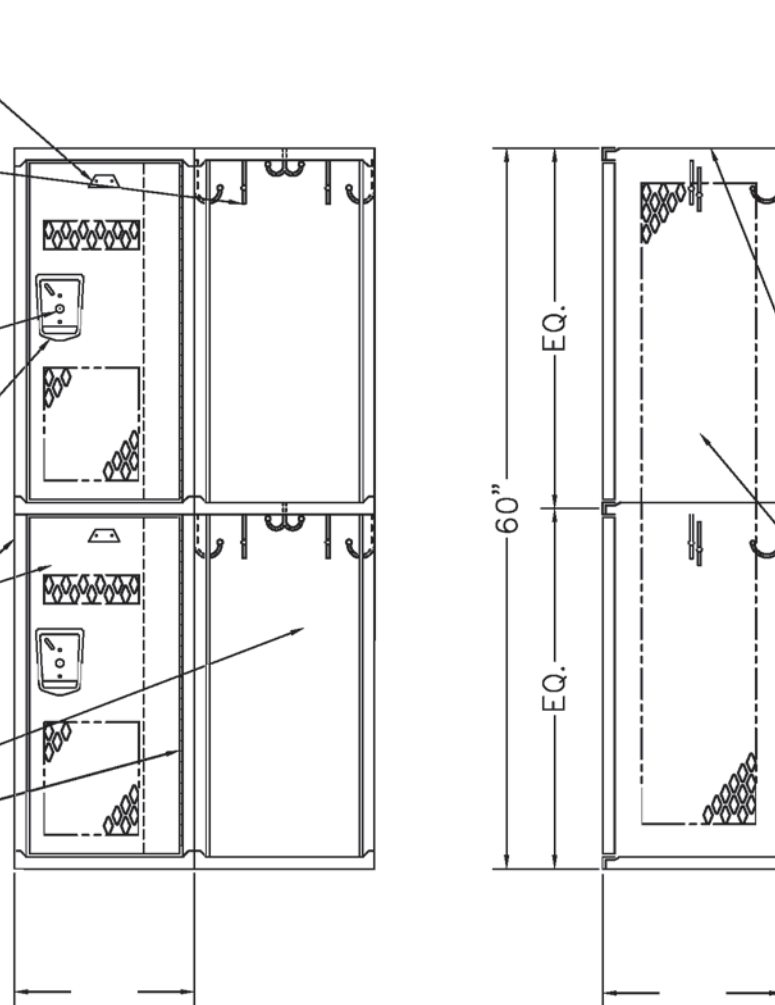

ANCHOR LOCKERS TIGHT  
TO WALL @ 36" O.C.  
(ANCHORS BY OTHERS)

16GA. TOP, BOTTOM &  
SHELF/TIER HEAD

16GA. DIAMOND PERF. DIVISION  
SOLID @ ROW ENDS

Sold By  
**SchoolLockers.com**  
877.952.0151

# 60" HIGH DOUBLE TIER INVINCIBLE II DEFIANT II LOCKER

TYPICAL FOR >18" WIDE  
TYPICAL FOR 18", 21" & 24" DEEP

ALUMINUM NUMBER PLATE  
(FIELD INSTALL)

TOW DOUBLE PRONG CEILING  
HOOK & FOUR SINGLE PRONG  
WALL HOOKS EACH OPENING  
(FIELD INSTALL)

LOCK HOLE COVER PLATE

STAINLESS STEEL DEFIANT  
HANDLE W/ PADLOCK HASP

16GA. FRAME ASSEMBLY &  
14GA. DIAMOND PERF. DOOR W/  
REINFORCMENT PAN

18GA. SOLID BACK

CONTINUOUS HINGE

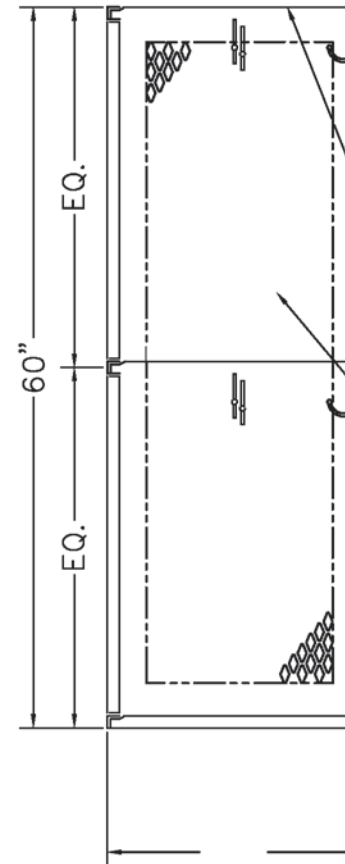

ANCHOR LOCKERS TIGHT  
TO WALL @ 36" O.C.  
(ANCHORS BY OTHERS)

16GA. TOP, BOTTOM &  
SHELF/TIER HEAD

16GA. DIAMOND PERF  
DIVISION, SOLID @ ROW  
END

ALLOW 1/16" CREEPAGE PER FRAME

Sold By

**SchoolLockers.com**

877.952.0151

99 BROWER AVE. P.O. BOX 378 OAKS, PA 19456-0378  
TEL: (800) 562-1000, (610) 666-0500 FAX: (610) 666-7561

This drawing shows a standard Penco Product. Any Modification  
to the product must be approved by Penco Engineering. 9/15/2006

242160INVD2T.DWG



# 72" HIGH DOUBLE TIER INVINCIBLE II DEFIANT II LOCKER

TYPICAL FOR 15" & 18" WIDE  
TYPICAL FOR 15" , 18" , 21" & 24" DEEP

ALUMINUM NUMBER PLATE  
(FIELD INSTALL)

ONE DOUBLE PRONG CEILING  
HOOK & FOUR SINGLE PRONG  
WALL HOOKS EACH OPENING  
(FIELD INSTALL)

LOCK HOLE COVER PLATE

STAINLESS STEEL DEFIANT  
HANDLE W/ PADLOCK HASP

16GA. FRAME ASSEMBLY &  
14GA. DIAMOND PERF. DOOR W/  
REINFORCMENT PAN

18GA. SOLID BACK

CONTINUOUS HINGE

Sold By

**SchoolLockers.com**

877.952.0151

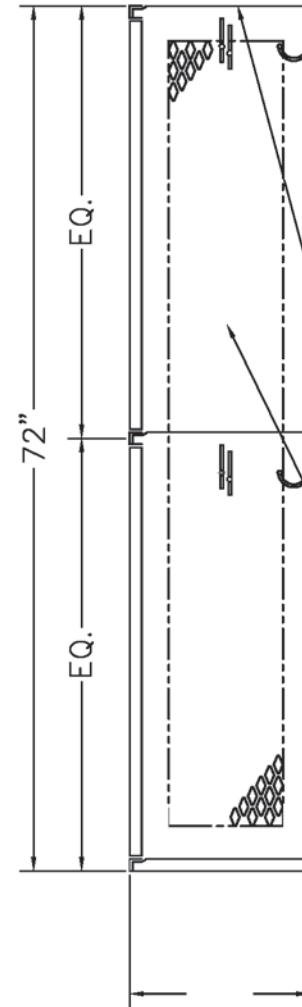
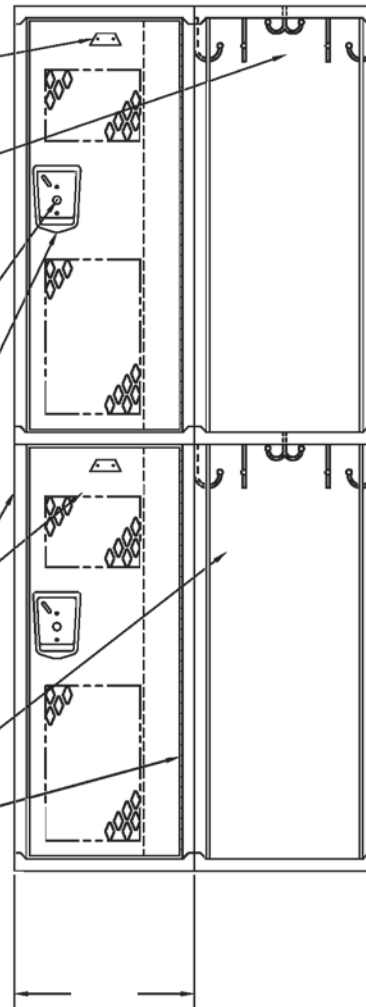

ANCHOR LOCKERS TIGHT  
TO WALL @ 36" O.C.  
(ANCHORS BY OTHERS)

16GA. TOP, BOTTOM &  
SHELF/TIER HEAD

16GA. DIAMOND PERF. DIVISION  
SOLID @ ROW ENDS

ALLOW 1/16" CREEPAGE PER FRAME

# 72" HIGH DOUBLE TIER INVINCIBLE II DEFIANT II LOCKER

TYPICAL FOR > 18" WIDE  
TYPICAL FOR 18", 21" & 24" DEEP

ALUMINUM NUMBER PLATE  
(FIELD INSTALL)

TOW DOUBLE PRONG CEILING  
HOOK & FOUR SINGLE PRONG  
WALL HOOKS EACH OPENING  
(FIELD INSTALL)

LOCK HOLE COVER PLATE

STAINLESS STEEL DEFIANT  
HANDLE W/ PADLOCK HASP

16GA. FRAME ASSEMBLY &  
14GA. DIAMOND PERF. DOOR W/  
REINFORCMENT PAN

18GA. SOLID BACK

CONTINUOUS HINGE

ANCHOR LOCKERS TIGHT  
TO WALL @ 36" O.C.  
(ANCHORS BY OTHERS)

16GA. TOP, BOTTOM &  
SHELF/TIER HEAD

16GA. DIAMOND PERF  
DIVISION, SOLID @ ROW  
END

ALLOW 1/16" CREEPAGE PER FRAME

Sold By

**SchoolLockers.com**

877.952.0151

99 BROWER AVE. P.O. BOX 378 OAKS, PA 19456-0378  
TEL: (800) 562-1000, (610) 666-0500 FAX: (610) 666-7561

This drawing shows a standard Penco Product. Any Modification  
to the product must be approved by Penco Engineering. 9/15/2006

241872INVD2T.DWG

