

LOCKER HOOK ARRANGEMENTS

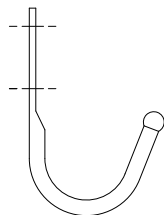

SINGLE PRONG WALL HOOK

(SGL. PRNG)

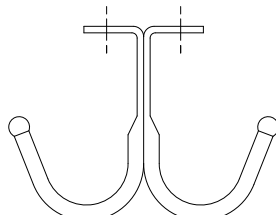

DOUBLE PRONG CEILING HOOK

(DBL. PRNG)

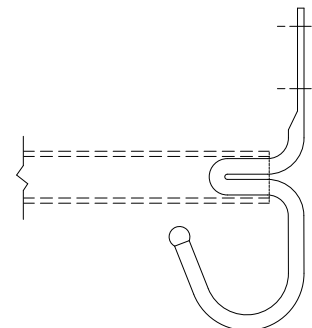

SINGLE PRONG WALL HOOK
WITH COAT ROD

(COAT ROD W/ HOOKS)

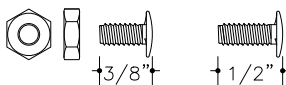
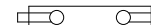

↑ 3/8" ↑

↑ 1/2" ↑

3/8" USED AT END APPLICATIONS
1/2" USED AT INTERMEDIATE APPLICATIONS

INVINCIBLE II SINGLE PRONG HOOK ARRANGEMENTS

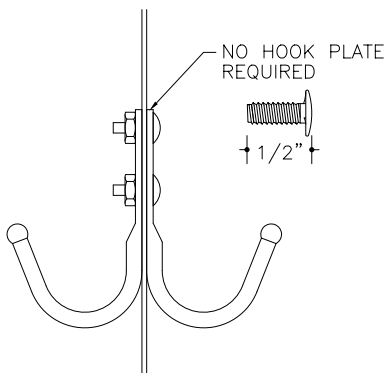

INTERMEDIATE HOOK ARRANGEMENT

NO HOOK PLATE
REQUIRED

↑ 1/2" ↑

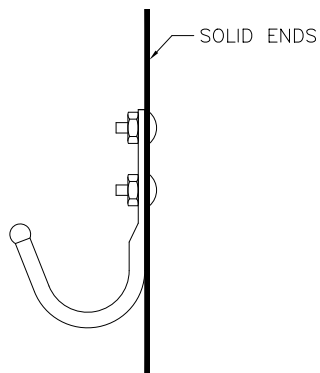

SOLID END HOOK ARRANGEMENT

SOLID ENDS

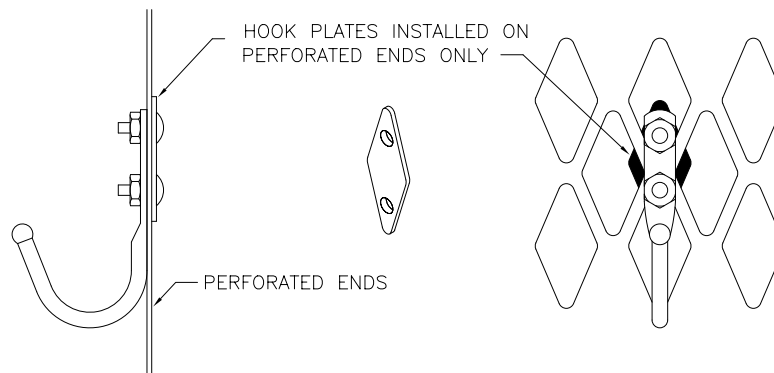

EXPOSED END HOOK ARRANGEMENT

HOOK PLATES INSTALLED ON
PERFORATED ENDS ONLY

PERFORATED ENDS

FRONT VIEW

Sold By

SchoolLockers.com

877.952.0151



HOOK DETAILS.dwg

This drawing shows a standard Penco Product. Any modifications to the product must be approved by Penco Engineering. 8/6/2001